



ART OSAKA

ART OSAKA 2025

Expanded section

Venue: Creative Center Osaka
-Application Guidelines-

Exhibitor Application Period

November 8 (Fri), 2024 - December 15 (Sun), 2024, 11:59pm

Preliminary inspection of the exhibition site

November 26 (Tue), 2024 1:00pm-

Application Deadline

November 25 (Mon)

*If the schedule does not work for you, we can accommodate individual requests. Please contact the office.

*Preview meetings will also be held after February and after exhibitors have been selected.

*Please see p.16 for details on each application.

Table of Contents

Outline

ART OSAKA 2025 InformationP. 1
What is Expanded?P. 2
Outline of Expanded sectionP. 3
Schedule for the three venues (carry-in/out)P. 3

Exhibition venue materials

Creative Center OsakaP. 4
Former general office building 1st to 4th floorP. 4~6
Red FlameP. 6
Overall layout of the CCO venueP. 7

Application Guidelines

ScheduleP. 8
Entry qualificationsP. 9
Exhibit Fee	
Submission of Exhibition PlanP. 10
About the works to be exhibited	
About walls, lighting, fixtures, equipment, etc.P. 11
Carry-in and carry-outP. 11-13
About the transportation of artworksP. 13
Exhibitor RelationsP.14
Sales of Exhibits	
Price lists	
Photography	
Cancellations	
About Expanded PlusP. 15
Exhibitor ApplicationP. 16
Contact us	

This application guideline is for the Expanded section.

Please check the separate document for Galleries Section.

Announcement of ART OSAKA 2025

The Association for the Promotion of Contemporary Art in Japan (APCA) is pleased to announce that ART OSAKA 2025 will be held in July 2025. ART OSAKA has the longest history of any art fair in Japan having previously established itself as the pioneer of the hotel-style fair. In 2021, ART OSAKA took the important evolutionary step of moving to the Osaka City Central Public Hall (a nationally designated Important Cultural Property) and becoming a floor-style fair. In 2022, on the occasion of its 20th anniversary, ART OSAKA made the an unprecedented move in Japan of opening a section specializing in large-scale works to attract new buyers.

[Features of ART OSAKA]

- ART OSAKA specializes in contemporary art and has been held 22 times (also as a hotel-style fair from 2007 to 2019).
- The fair serves as a platform for viewers to witness the trends of young to mid-career contemporary artists in Japan.
- Many museum curators, independent curators, and other art professionals visit the fair every year.
- The fair has become a catalyst for artists to develop their careers through exhibitions at art museums and art festivals in Japan and abroad.

This year, ART OSAKA will be held in two sections, as a continuance of last year's efforts. ART OSAKA aims to create an improved environment for talented artists to showcase their work and a place to sell a wide variety of art. We hope that you will consider exhibiting at ART OSAKA.

<https://www.artosaka.jp/>

Galleries section [Nakanoshima Area] : Date June 6 (Fri) ~ 8 (Sun), 2025

Osaka City Central Public Hall (National Important Cultural Property) 3rd Floor

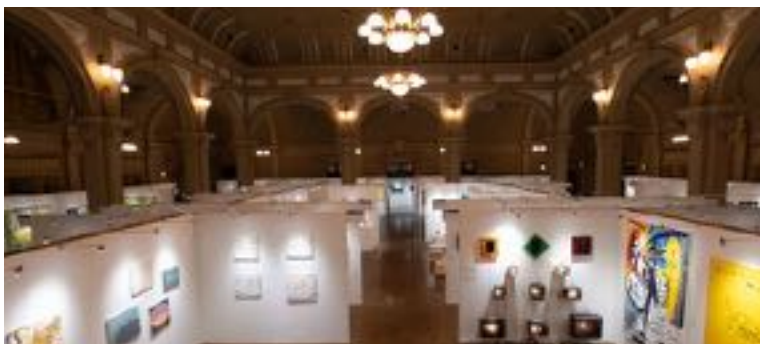

CANDYBAR Gallery

Expanded section [Kitakagaya area] : Date June 5 (Thu) ~ 9 (Mon), 2025

Creative Center Osaka



Nishiyama Minako / Yoshimi Arts



Nakayashiki Tomonari / KOKI ARTS

What is the Expanded Section?

As an unprecedented move among Japanese art fairs, the Expanded Section was launched in 2022 to specialize in the exhibition and sale of works unable to be accommodated in the conventional booth format—these include large-scale work, installations, and site-specific works. This section is held in unique art spaces that are run in a modern industrial heritage building (a former shipyard). These venues bring out the best in artistic talent and offer new perspectives with their diverse range of large-scale works. Now in its third year, the Expanded Section has been well received by visitors and other interested parties alike, and with the cooperation of Chishima Real Estate Co., Ltd. and in cooperation with the cultural facilities in the Kitakagaya area, this side of ART OSAKA continues to show strong growth year by year.

Expanded Section Statement:

We have named ART OSAKA's new endeavor Expanded.

This is not only because the venue will be expanded from the Osaka City Central Public Hall to the vast site of the former Namura Shipbuilding Osaka Factory, but also because it is a literal 'expansion' of art. The move is more than just increasing the physical size and capacity of works: it also includes the idea of expanding the boundaries of media such as painting, sculpture, and video works, and expanding our visitor's perceptions of contemporary art. Therein lies the basic idea of stepping outside the realm of preconceptions. The latest ART OSAKA theme will be various attempts at 'expansion'. Everyone is invited to step with us outside of existing images of 'art', and encounter new discoveries and ideas.

ART OSAKA 2024 Expanded section Exhibition view



Nishino Kozo / ARTCOURT Gallery



Osawa Hal / biscuit gallery



Sunghong Min, Sanghoon Ahn / gallerychosun



Kevin Lee / GALLERY HAYASHI + ART BRIDGE

Outline of Expanded Section

Dates: **June 5 (Thu) - 9 (Mon), 2025** [Galleries section: June 6 (Fri) - 8 (Sun)]

Open to the public: 5 (Thu) 1:00pm - 7:00pm
 6(Fri)~8(Sun) 11:00am - 7:00pm
 9(Mon) 11:00am - 5:00pm

Carry-in: 2(Mon)~4(Wed) 10:00am - 7:00pm
 5 (Thu) 9:00am - noon

Carry out: 9(Mon) 5:00pm - 9:00pm
 10(Tue) 10:00am - 5:00pm *Fully closed

*Please note that hours are subject to change.

Venue: **Creative Center Osaka(CCO)**
 4-1-55 Kitakagaya, Suminoe-ku, Osaka 559-0011, Japan

Access: Kitakagaya station on the Osaka Metro Yotsubashi Line
 Free shuttle bus service between the public hall and CCO will be available from June 6 (Fri.) to 8 (Sun.).

Number of applicants: Approx. 15~20 galleries

Admission: ART OSAKA Ticket *Admission to all venues.

Online Tickets: ¥3,500 / Same-day purchases: ¥4,000

Expanded only tickets: ¥1,500 Same-day payments only.

Estimated number of visitors: approx. 5,000 people

Official website: <https://www.artosaka.jp>

Organizer: Association for the Promotion of Contemporary Art in Japan (APCA)

Special Sponsor: Chishima Real Estate Co., Ltd.

Sponsor: Now accepting applications (inquiries also welcome)

Schedule for the three venues (carry-in/out)

	Jun. 2 (Mon)	Jun. 3 (Tue)	Jun. 4 (Wed)	Jun. 5 (Thu)	Jun. 6 (Fri)	Jun. 7 (Sat)	Jun. 8 (Sun)	
Galleries-Public Hall	-	-		Carry in	preview 1pm-7pm	Open to the public 11am - 7pm	Open to the public 11am-6pm	carry out
Expanded-CCO	Art work installation			Opening 2pm-7pm	2nd day 11am - 7pm	3rd day 11am - 7pm	4th day 11am - 7pm	
	Jun. 9 (Mon)	Jun. 10 (Tue)	Jun. 11 (Wed)	Jun. 12 (Thu)	Jun. 13 (Fri)	Jun. 14 (Sat)	Jun. 15 (Sun)	
Galleries-Public Hall		-	-	-	-	-	-	
Expanded-CCO	5th day 11am-5pm	carry out	Spans day	-	-	-	-	

*If you have any questions about the exhibition venue or application, please feel free to contact us.

Exhibition venue materials

Creative Center Osaka(CCO)

4-1-55 Kitakagaya, Suminoe-ku, Osaka 559-0011, Japan <https://goo.gl/maps/bCwSTNTcifgcavFT7>

Web <https://www.namura.cc> / 360 video <https://www.youtube.com/watch?v=k K1w0-5CA&t=125s>

ART OSAKA 2022 VR <https://matterport.com/discover/space/SuHgT3gctWQ>

Creative Center Osaka (CCO) is located at the mouth of the Kizu River, in Osaka City's Suminoe-ku area, where for almost half a century from 1932-1979 it was the site of the Namura Shipbuilding Factory. After the factory's relocation, the site lay dormant from 1998 until 2004, when the Namura Art Meeting was held and Creative Center Osaka (CCO) established the following year. Numerous cultural events have been held since its opening. In 2007 it was recognized as modern industrial heritage.

Exhibition venue

The first through fourth floors of the former general office building at Creative Center Osaka, along with the outdoor exhibition space featuring red steel beams, are potential venue candidates.

*Note: The 4th Floor Drafting Room and the Aka Tekkotsu (Red Steel Beam Area, Outdoor) will be considered exhibition venues upon consultation, depending on requests.

▼Former general office building, 1st floor

BLACK CHAMBER

Hall area 220m² (including 33m² for 2nd floor seats), width: 10m x depth 18m, ceiling height 6.3m

• Lighting: Stage lighting • Movable Wall: No

*Lighting will be installed and adjusted by the facility staff.



Ground plan view

2nd floor atrium

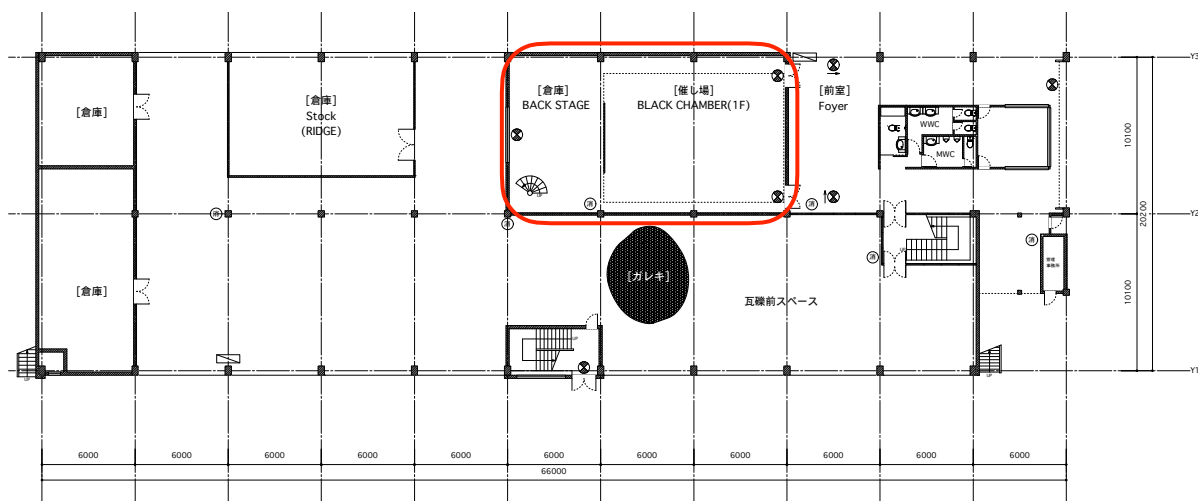

▼Former general office building, 2nd floor

WHITE CHAMBER/Hall area 450m², frontage 19m x depth 26m, ceiling height 3.3m

- Lighting: 10~20 lights per gallery. Free rental.
- Movable Wall: No • Carrying in/out: Stairs only



Ground plan view

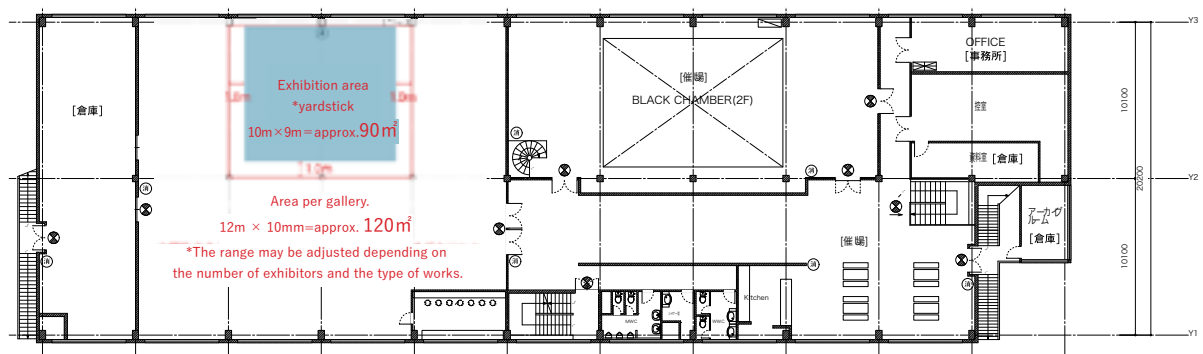

▼Former general office building, 3rd floor Free space / Area 1320m², ceiling height 3.3m



- Lighting
10~20 lights per gallery.
Free rental.
- Movable Wall: available (Venue equipment)
H2020 mm × W2400 mm × D500 mm
- Carrying in/out:

Ground plan view

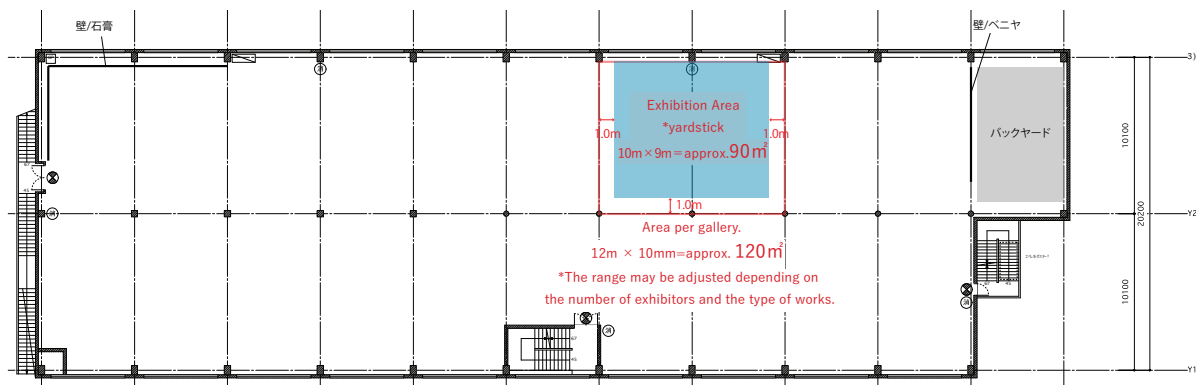

▼Former general office building, Drafting room, 4th floor / Area approx. 1320m², frontage 20m, depth 60m



- No air-conditioning
- Lighting: built-in fluorescent lamp
- Movable Wall: No
- Carrying in/out: Internal stairs or external stairs,

Cargo elevator

*The winch cannot be used.

図面

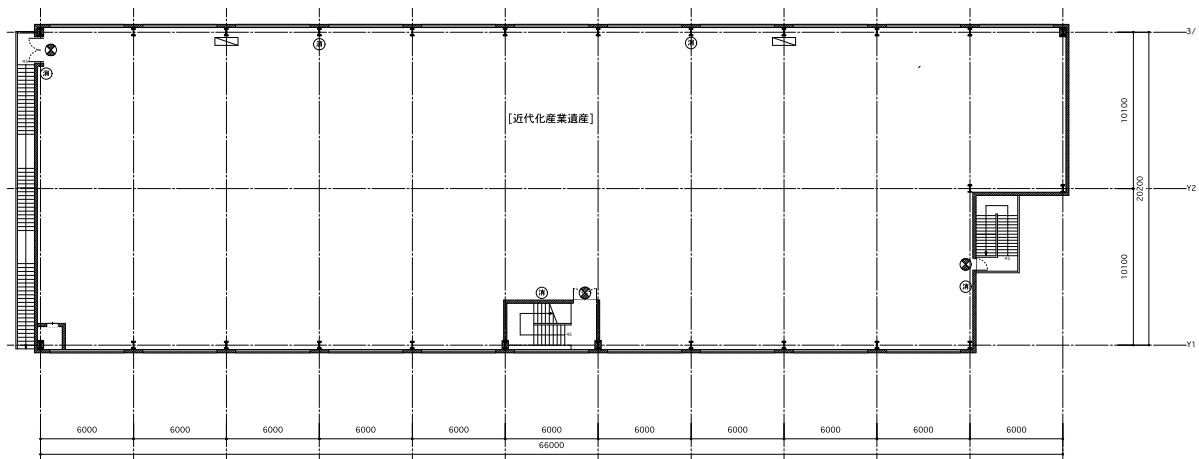

▼Red frame (outdoors)

Area 300m² Width 15m Depth 20m



- Lighting : 4 mercury lamps in the ceiling.

Important note: Although there is a roof, the area is exposed to the elements, so only artworks suitable for outdoor display will be accepted.

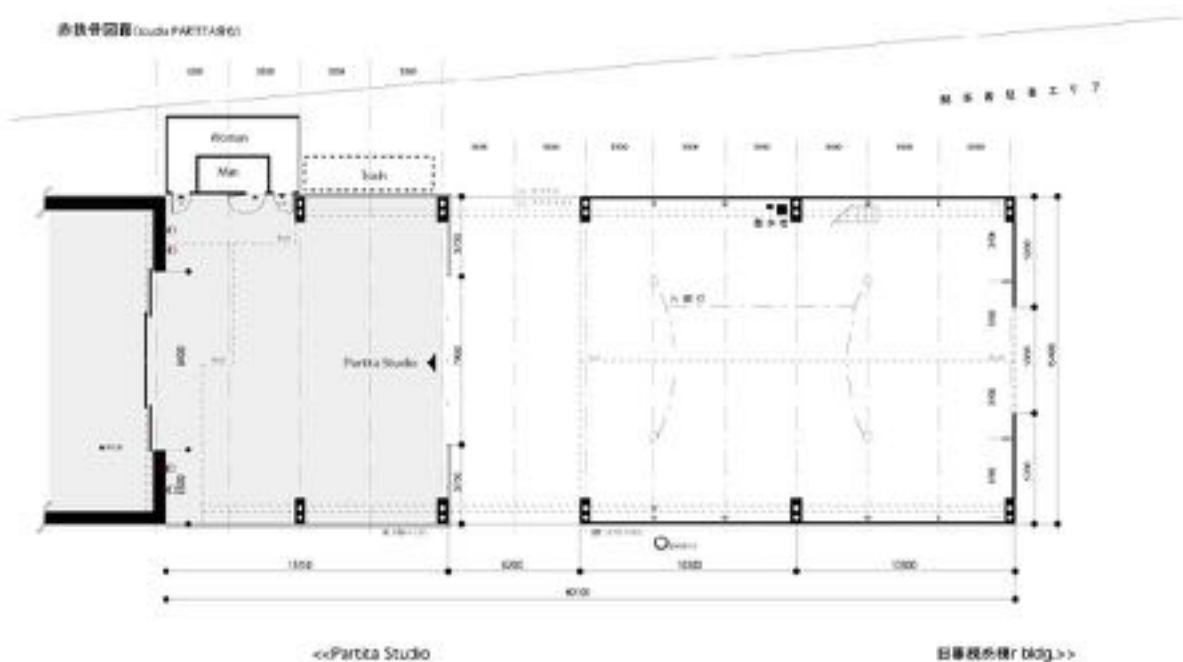

Overall layout of the CCO venue

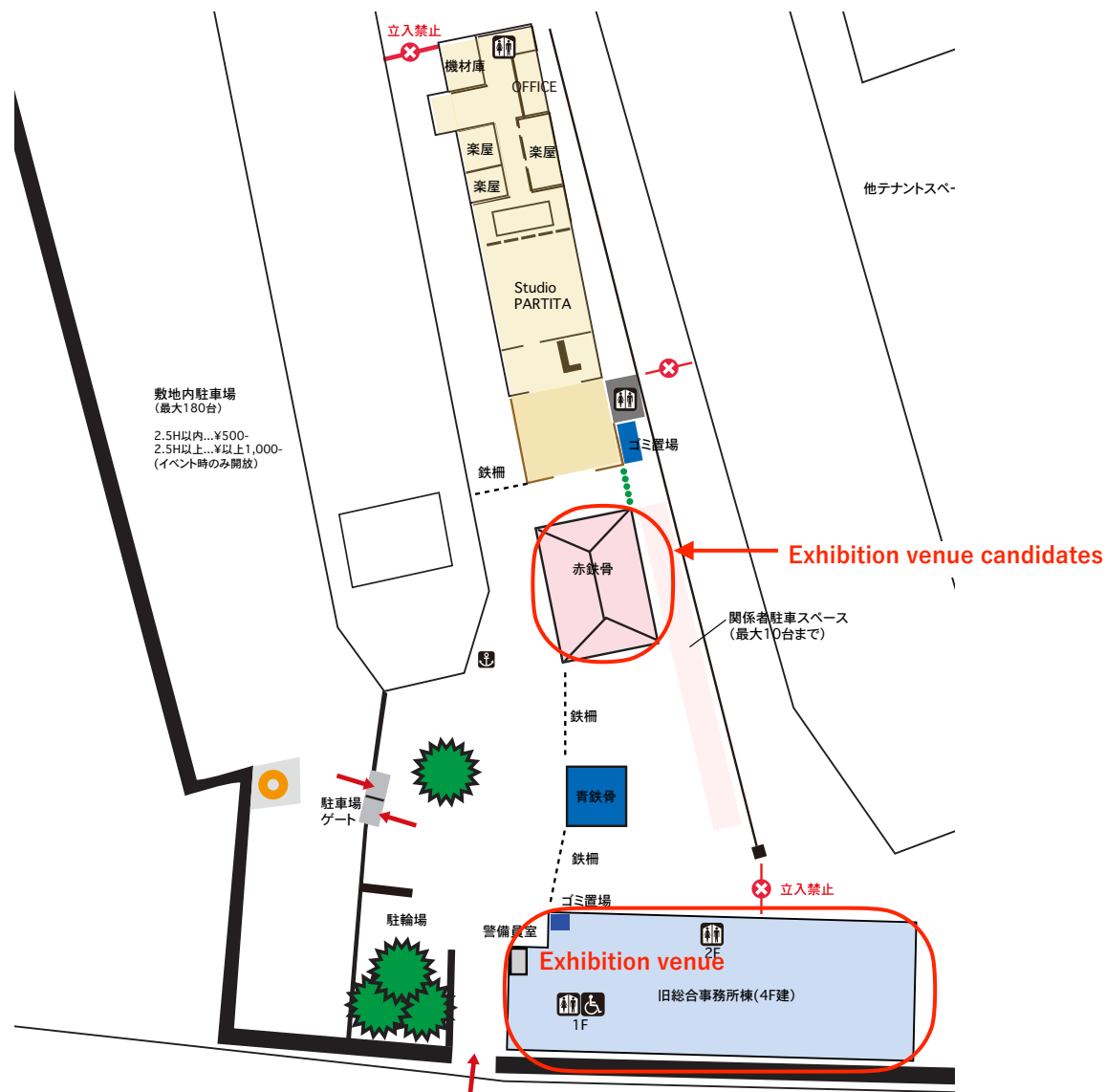

Expanded Section Application Requirements

NOTICE !

- The contents of the Exhibitor Guide are subject to change as required.
- Please apply to participate only after thoroughly reading and agreeing to abide by the contents of this guide.

Schedule *Subject to change.

Preliminary inspection of Creative Center Osaka	Nov. 26(Tue.), 2024 1:00pm- *Now accepting applications
Application Period *Exhibit artist information and work plan must be submitted.	Nov. 8(Fri.), 2024 - Dec. 15(Sun.) 2024, until 11:59pm
Determination of participating galleries and exhibition locations	Late January
Preliminary inspection of Creative Center Osaka *This offer is open to galleries that have been selected to exhibit.	Scheduled to be held in Early February
Deadline for collection of information for print and web	Mid-February (details to be announced at a later date)
Deadline for payment of entry fee	Late February
Submission of artwork plans according to exhibition location *Please submit only if the exhibition location or other details have changed since your application. *After submitting the plan, our staff will consult with you directly about exhibition methods, and carry-in and carry-out. Coordination with adjacent artworks and venues will also be discussed as necessary. *Any significant changes without prior notice may result in the possibility that your participation will be canceled.	Mid- March
Shipping of printed materials and invitation tickets	Late March
Finalization of work plan *Since we need to submit an Event Notification Form to the fire department, we will ask you to submit a document with a rough diagram of the artwork layout. There is no problem if you change the layout of artworks on the day of set-up.	Late April
Deadline for submitting information on artworks to be displayed on the floor map	Early to mid April
Deadline for submitting information on artworks to be displayed on the floor map	
Start of Fair	June 5th (Thu.) - 9(Mon.), 2024

*Please see p.16 for details of each application.

Entry qualifications

In accordance with the eligibility requirements for the Galleries section of ART OSAKA 2024, the following criteria have been established

- 1. The gallery must present an exhibition of primary work by contemporary artists at least twice a year**
- 2. The gallery must have been established for at least three years**

- Galleries established for less than three years may also be eligible to participate upon consideration of their policies and activities.
- If you are a first-time participant, please send us an attached document that describes your gallery's management policy, history of past exhibitions, and the director's background (any format is acceptable).
- The final decision as to whether or not you are eligible to participate will be made by the organizer.
- Please be advised that the selection of exhibitors is conducted by a panel of judges based on the submitted work plans.
- Please try to refrain from exhibiting the same artist consecutively.
- **One artist or one collective (unit) per plan is recommended.**
- **Only one exhibit per gallery is allowed per plan.**
- **Multiple galleries may exhibit together for one plan.**

Exhibition fee

Creative Center Osaka(CCO)	Exhibition fee *Tax include	
Former general office building, 1st floor BLACK CHAMBER	If you exhibit only in the Expanded section	Please contact us. : info@artosaka.jp
	For exhibitors in both Expanded and Galleries sections	
Former general office building, 2nd floor, 3rd floor, 4th floor Red Flame	If you exhibit only in the Expanded section	
	For exhibitors in both Expanded and Galleries sections	

Deadline for payment of exhibition fee: **The end of February**

■ Fee includes

- | | |
|--|---|
| • Exhibition space rental fee | • Staff pass and artist passes (about 4 in total) |
| • Spotlight (*Please see p.11 for details.) | • Party (reception) participation fee for 2 persons |
| • Gallery signage and captions | Scheduled for June 6 (Fri.) at the Public Hall |
| • Information (flyers, posters, official website, SNS) | after the fair |

The number of flyers and tickets below varies depending on the section in which you are exhibiting.

- Posters, flyers
- VIP/General Invitation Tickets will be given for admission to all venues.

(Invitation tickets will be sent to exhibitors late March.)

- ※No refunds of entry fees will be accepted for any reason, except reasons attributable to the organizer.
- ※All costs associated with exhibiting works (transportation, insurance, materials, equipment rental, assembly and disassembly costs) are to be borne by the exhibitor.

Submission of Exhibition Plans, etc.

When applying, please submit the following

① Artist Information

Please use the designated format.

② Exhibition plan and images of past works

Please submit as detailed an exhibition plan as possible, as it will be necessary when considering the exhibition location. Please submit your exhibition plan in a format of approximately 5 A4 pages.

- * Please understand that we may not be able to accommodate your requests for exhibition locations.
- * After you have been selected as an exhibitor, you will be asked to prepare a plan according to the exhibition location after consulting with the fair staff (from early April to early June).
- * As a rule, major changes to the plan, such as the concept, etc., are not permitted.
- * We may ask you to change the contents of your exhibit to comply with fire laws and regulations.
- * Please carefully check the concept of this section and consider the plan of your work.

About the works to be exhibited

We welcome works that 'expand' conventional ideas of art, beyond size

Genres : Two-dimensional, three-dimensional, photographic, video, mixed media, installation, and site-specific works created through research of the local area.

Exhibition Space:

Floor space: 100~120m² approx.

Height: 2300mm~3470mm * This range is not limited to the black chambers and outdoor exhibits.

Noise volume regulations for Creative Center Osaka:

8:00am -18:00pm 70dB / 6:00pm-9:00pm 65dB

*Please be considerate to other exhibitors on the same floor when exhibiting sound-producing works.

[Notes]

- Items will be carried in via the stairs. Please consult with the fair staff in advance regarding the delivery of heavy items and pieces whose parts are larger than front entrance to the fair.
- The extent of the exhibition area may be subject to change depending on the conditions of the exhibition location and the artwork.
- Please consider the plan after fully confirming the size of the delivery route and entrance size.

About walls, lighting, fixtures, equipment, etc.

• **Movable Wall (Venue Equipment)**

Creative Center Osaka

H2020 mm × W2400 mm × D500 mm

Weight: up to 20 kg per item

*Pins or screws may be used. Restoration to the original state is required.

*From this year's event, the secretariat will no longer set up temporary walls.



• **Lighting**

10~20 lights per gallery. *Please consult with the secretariat staff to determine the number of lights required.

Specifications: as per previous event

LED lamps

Color temperature: 5000K

Luminous flux: 600 lm

Light distribution angle: 36°

Power consumption: 6.5W

If you wish to use lights other than those listed above, please provide your own

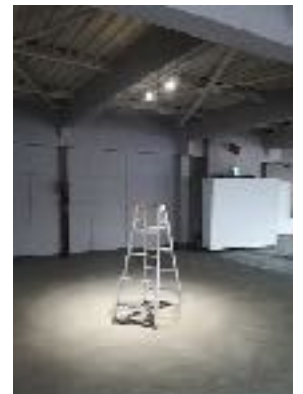

• **Fixtures**

We can provide fixtures for a fee. Please contact the secretariat for details.

• **Bringing in equipment**

If you wish to bring your own equipment, please let us know in advance, as we need to check the electrical capacity and report to relevant facility managers.

Carry-in and Carry-out

Schedule

*Times are subject to change.

Carry-in June 2(Mon)-4(Wed) 10am - 7pm

June5(Thu) 9am - noon

Carry-out 9(Mon) 5pm - 9pm

10(Tue) 10am - 5pm *Building completely closed

- Exhibitors are responsible for carrying in, setting up, and taking down their works.
- Items will be carried in via the stairs.
- Please check the entrance widths and the carry routes sufficiently, and plan your method of carrying in the exhibits well in advance.

*The organizer will not be held responsible for any accidents that may occur during carry-in and carry-out.

Various entrance measurements

Creative Center Osaka

1st Floor / Black Chamber



▼Back of the building, carry-in entrance

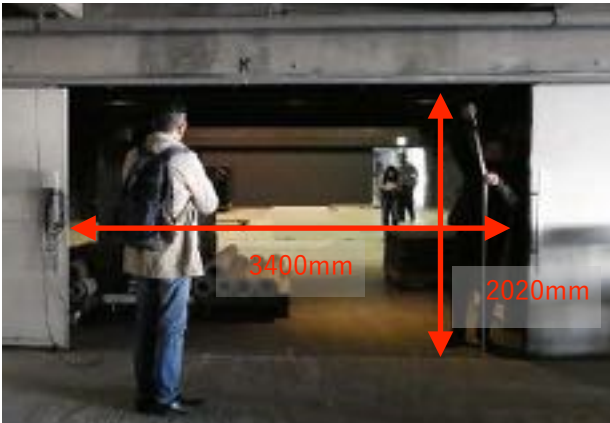

▲Main entrance



North entrance on 2F and 3F *Please consult with us for delivery of heavy or oversized items.



Cargo elevator

Stops at 1st, 3rd, and 4th floors *Does not stop at 2nd floor

Opening: W850 × H1100(mm)

Inside: W850 x H1150 x D1150(mm)

Loading capacity: 200 kg



Winch

The winch shown in the attached image can be used to transport heavy materials and artwork.

However, only objects that fit in the basket can be used.

Can be used on the 3rd floor only *Cannot be used for carrying items in and out on the 2nd and 4th floors.



Winch rated capacity: 200 kg

Basket cart size (internal measurements):

Width 730 x Depth 570 x Height 1800mm

Entrance for winch: 3rd floor
South Door size
W730 × H2100mm

About the transportation of artworks

- For those who use Marutake (art transportation), the secretariat is planning to have all work picked up and dropped off in a single shipment. We will inform you of the pickup schedule, etc. as soon as possible. Other transportation options, such as private cars or other carriers, are also available.
- Galleries planning for international transportation will be contacted promptly after the exhibition decision to discuss the loading and unloading methods.

EXHIBITOR RELATIONS

Ryoichi Matsuo / Owner of TEZUKAYAMA GALLERY (director of APCA)

Satoshi Sakuraoka / Owner of FINCH ARTS

Ryoichi Matsuo and Satoshi Sakuraoka will be in charge of consulting with exhibitors and coordinating the installation of artworks. The contact person for each gallery will be contacted after all exhibitors have been selected.

Sales of Exhibited Works

If you are exhibiting in two sections and it is difficult to have staff at both site, please let us know in advance so that our office can contact you regarding the necessary arrangements. We appreciate your understanding in this matter.

Price List

Please prepare a price list to show visitors that the works on display are actually for sale.

Photography

During the fair, the secretariat will arrange for a photographer to take pictures of each booth for both archival and publicity purposes. In all cases we ask for your understanding and cooperation in this matter.

Cancellations

- No cancellations will be accepted once the exhibiting galleries have been selected.
- Cancellations may be accepted in the event of unforeseen circumstances such as disasters, or other unavoidable circumstances. Please note that even in such cases, cancellation fees will be charged as described below. Please contact the secretariat for details.
- A cancellation is considered to have occurred only when the cancellation fee has been paid.

Cancellation fee	After decision~end of February	40% of participation fee
	From March 1 to May 14	60% of the participation fee
	From May 15 to the day of the event	100% of the participation fee

【Notes for the period from carry-in to carry-out】

- Creative Center Osaka is located on a seaside site, and therefore has a breakwater on the premises. Please be advised that due to typhoons and other weather conditions, the breakwater may be closed and the facilities may not be available for use if ordered by the government. In such cases, the exhibition fee will not be refunded.
- If it becomes necessary to move or re-erect artworks due to the approach of a typhoon, the gallery will be responsible for this at its own expense.
- The organizer will not be responsible for any work that collapses or is severely damaged due to an unexpected natural disaster. Exhibitors are responsible for taking precautions such as protecting their works and purchasing insurance in advance.

About Expanded Plus

We plan to establish a space called 'Expanded Plus' within the venue to bring together, showcase, and sell small works by artists from the Expanded section. Please indicate your participation preference in the application document.

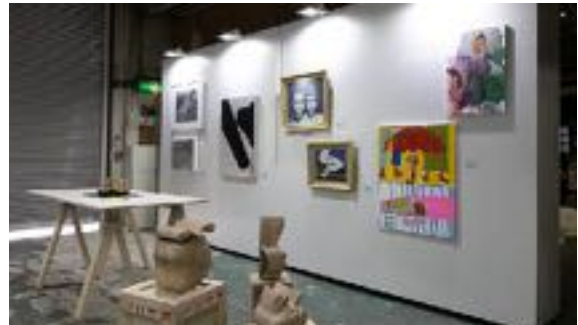

Participation conditions

- There is no additional exhibition fee for Expanded Plus. Participation is optional and only available for those who wish to join. It is not mandatory.

Due to limited space, there will be regulations regarding artwork sizes and the number of exhibited pieces.

- Exhibiting Artists: Only those exhibiting in the Expanded section
- Artwork Sizes: Paintings, size 50 (1,167 x 910 mm) / Sculpture 500 x 500 x 500 mm
- Number of Exhibited Works: 3 to 5 pieces
- Display Area: H2,000 x W1,000 mm

*The display area may vary depending on the number of applications.

*The occupied area for displaying sculptures will be subject to consultation based on the size and number of pieces.

*After the application deadline, additional information about the works will be collected.

Exhibition Location

- The exhibition locations will be determined by the office after deciding the overall layout.

Regarding Artwork Display

- Exhibitors are responsible for the installation and removal of their work. Please coordinate the loading and unloading in conjunction with the Expanded section. Further details will be communicated later.

Regarding Artwork Management

- Exhibitors may change their displayed works as needed. Generally, the office will not assist with this, so please handle it individually. Each exhibitor is responsible for the storage and management of all their works.

Regarding Sales

- The office will not be involved in payments or shipping for works sold. Please ensure that you handle all communications with customers regarding inquiries and purchases responsibly.

■ Exhibitor Application Period ■

November 8(Fri), ~ December 15(Sun) at 11:59pm

Send to: info@artosaka.jp

Please write "Application to exhibit at ART OSAKA 2025" in the subject line.

■ Application for a preview of the exhibition site ■

A preliminary inspection of the exhibition site will be held on the following date and time to prepare for the submission of exhibition plans. If you are unable to make it on the specified date, please feel free to contact the secretariat. Galleries that have been selected to exhibit are required to attend the preview if they have never been to the venue before, as it is necessary to fully check the loading entrance. (The event will be held again in late February.)

(Dates) November 26(Tue) 1pm~ **Deadline: November 25 (Mon), 2024**

Application by e-mail: info@artosaka.jp

Please put "ART OSAKA 2025 Expanded venue preview application" in the subject line.

▼Please supply us with the following information:

- Name of your gallery
- Names of participants
- Date of participation
- Number of participants
- Telephone number where we can reach you on the day
- Whether or not you will be coming by vehicle (& number of vehicles)
- Names of artists who will be exhibiting (where possible)

Contact us

Association for the Promotion of Contemporary Art in Japan (APCA JAPAN)

ART OSAKA Organizing Office | Contact: Murotani, Suzuki

3B Nakagawa Building, 5-6-7 Tanimachi, Chuo-ku, Osaka 540-0012 Japan

Tel: 06-6777-8303 / E-mail: info@artosaka.jp

*If you have any questions regarding the application or the exhibition, regardless of how detailed they may be, please feel free to contact us. The secretariat and staff members mentioned above are happy to respond in as much detail as they can.